



How to use a 3rd Party XMPP client to communicate via APAN Chat

1. Find, download, and install an XMPP chat client from your mobile devices app store.
 - *Example: Xabber*; chat app available from Google Play store on Android devices

Instructions for third-party apps are in the [APAN KB online](#), excerpt below:

- 1) Server: xmpp.apan.org
- 2) Protocol: XMPP
- 3) Port: 5222
- 4) Domain: xmpp.apan.org
- 5) Select Enable Connection Security
- 6) When prompted, Accept the apan.org certificate.

2. Open the **XMPP** chat app settings for your account login

- Server: **xmpp.apan.org**
- Username: your APAN account username
 - user@xmpp.apan.org
- Password: your APAN password (be sure to save so you don't have to keep typing it in again)

Note: you will of course need to register and establish your APAN account BEFORE attempting to use the chat client for APAN chat. Refer to instructions on www.apan.org, the APAN PE19 portal homepage, or email support@mpe.apan.org if you have problems accessing an account you've already created

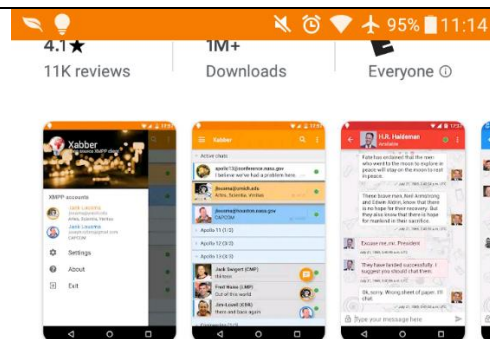

About this app

Open source XMPP (Jabber) client with multi-account support

Communication

Ratings and reviews

4.1

★★★★★

11,744

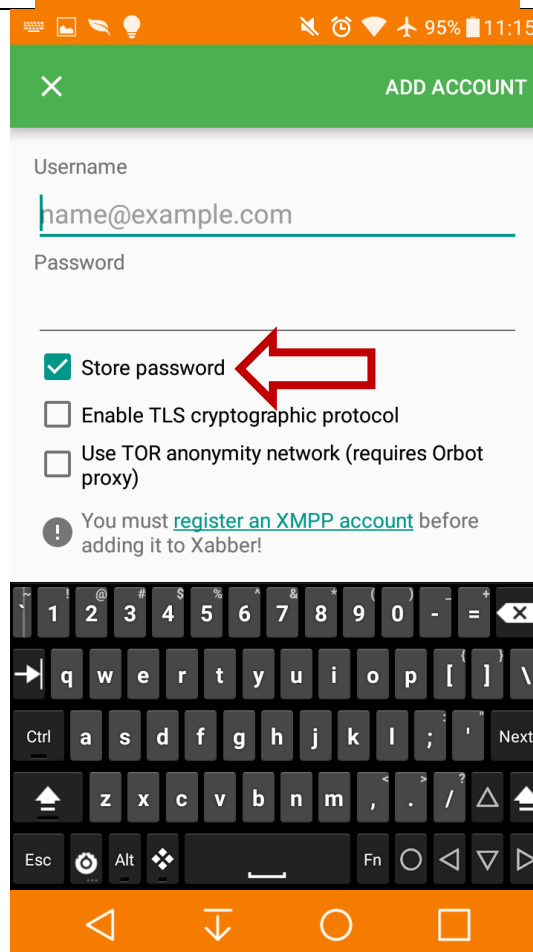
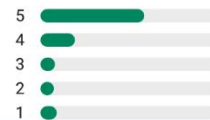

3. Verify you're connected and logged in to the APAN chat servers at xmpp.apan.org with the app settings
- Refer to app instructions for help or troubleshooting
 - Note: APAN staff members will try to help, but cannot usually assist with 3rd party client apps since we cannot access these from within our DOD facility
 - Contact APAN support if "authentication" fails or there are problems with your existing account

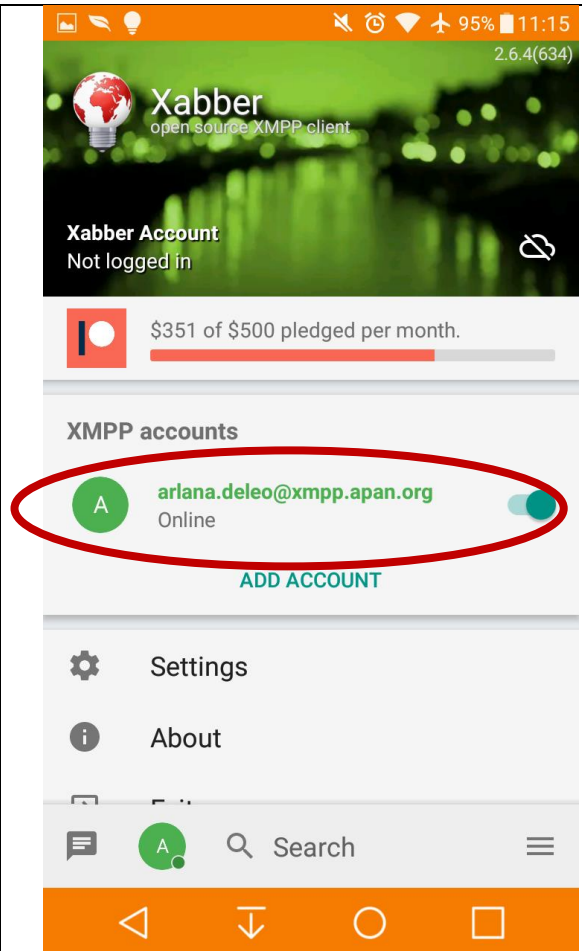

4. From the app menu or settings, find the option to add a group chat or "add conference", which equates to the APAN community chat rooms
- Controls and options for adding a "group" chat room will vary, depending on which 3rd party XMPP client you are using
 - The chat rooms may appear in a list; the rooms available will also depend on which APAN communities you're participating in as a member

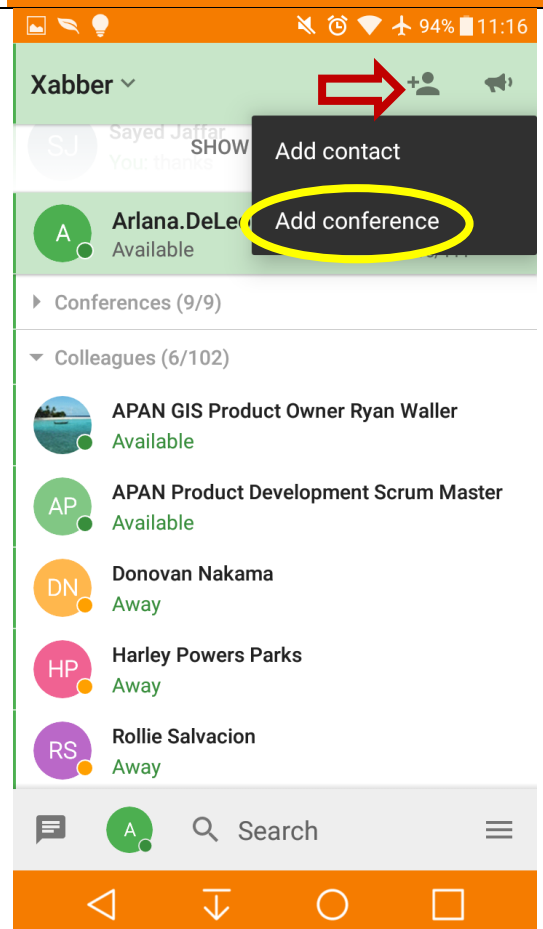

5. Input the name of the chat room – you may be able to find and select from a list or else type in the JID for the room. Examples used for PE19:

- PE19 All Hands Chat JID: **pe195777**
- MNCC only JID: **pe195867**
- DCP1 JID: **pe195868**
- DCP2 JID: **pe195869**
- DCP3 JID: **pe195870**

6. Select a chat room and send chat messages to communicate with other exercise participants.

- Example screenshots shown below for reference

